

S.R. 400 (I-4)

WORLD DRIVE

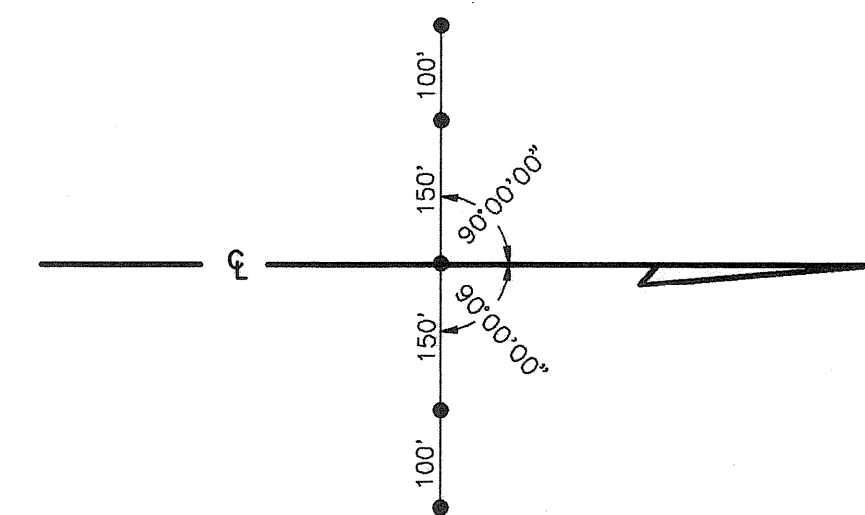

BEGIN R/W PROJECT
STA. 180+00

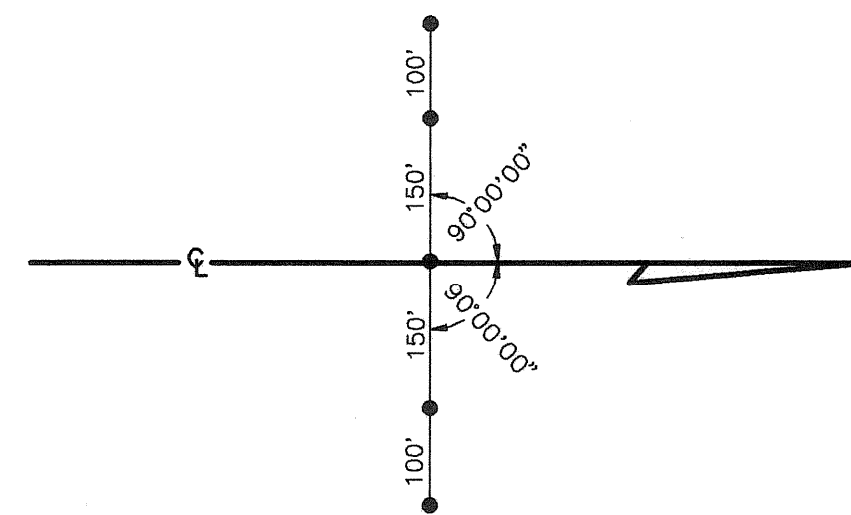

P.O.T.
STA. 190+00

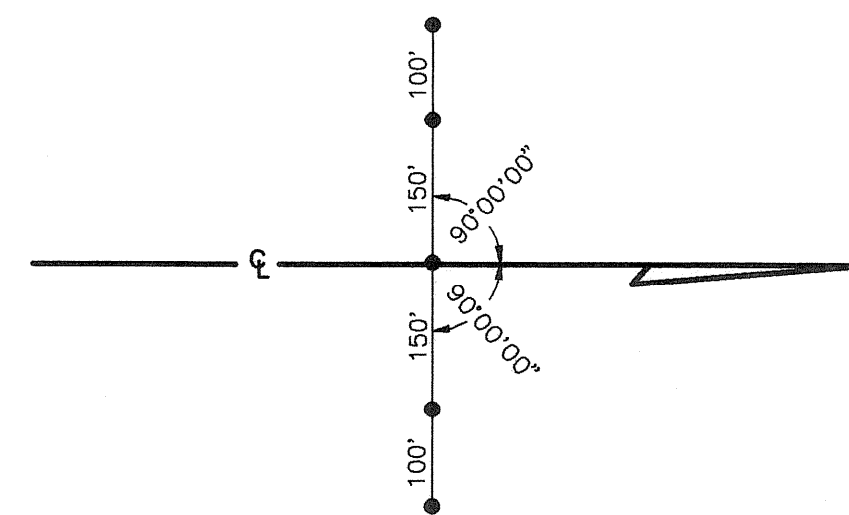

P.O.T.
STA. 200+00

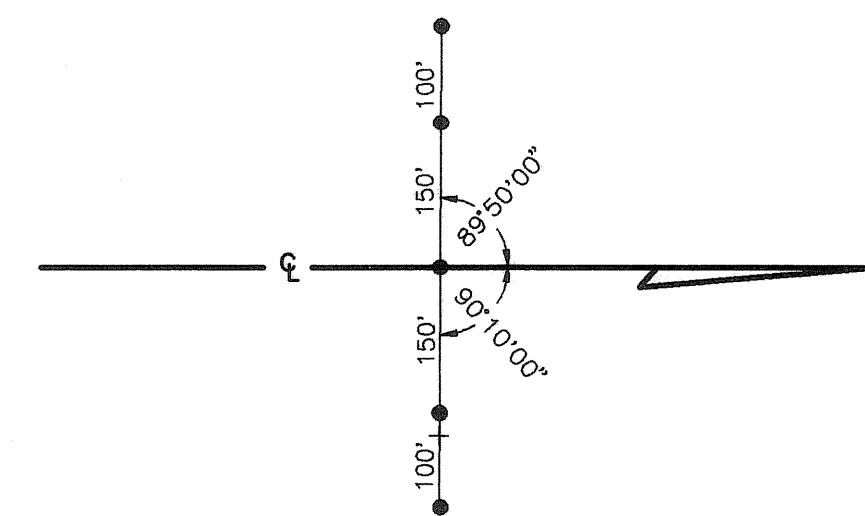

P.O.T.
STA. 210+00

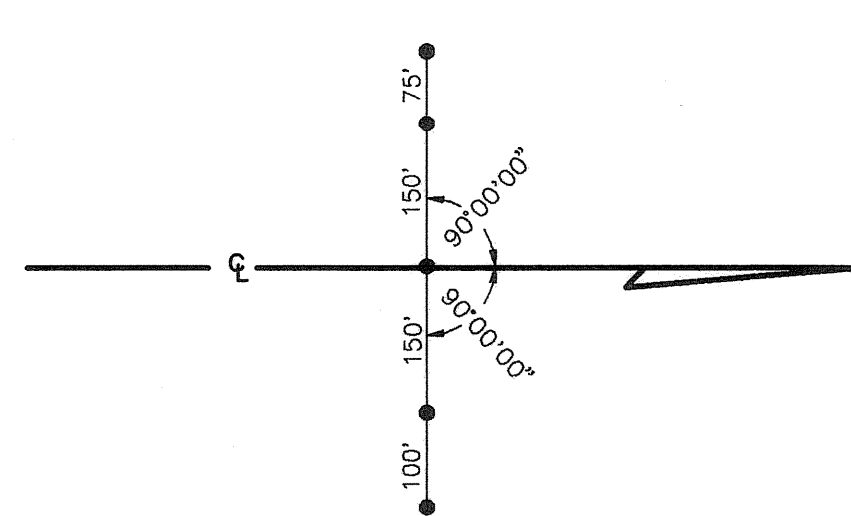

P.O.T.
STA. 220+00

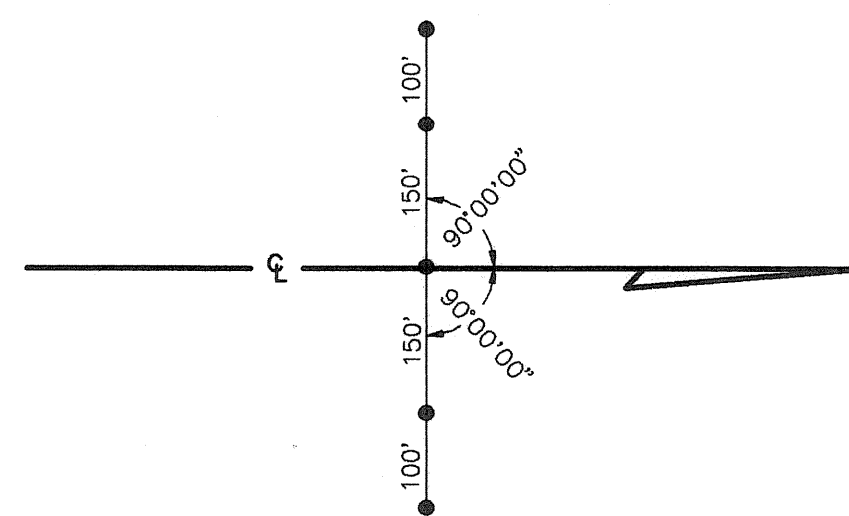

P.O.T.
STA. 230+00

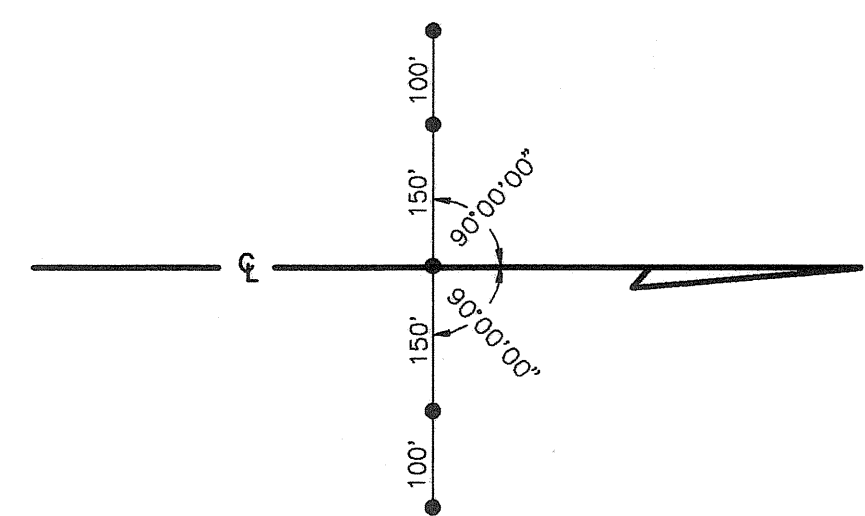

P.O.T.
STA. 240+00

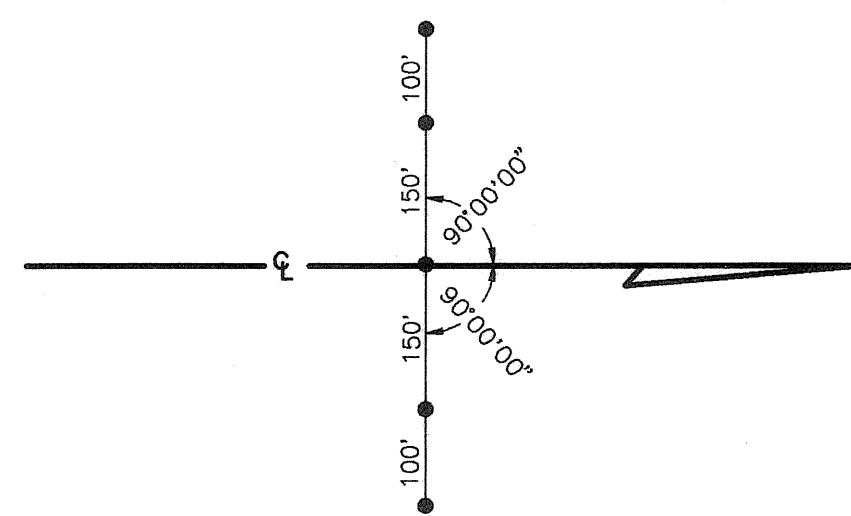

P.O.T.
STA. 250+00

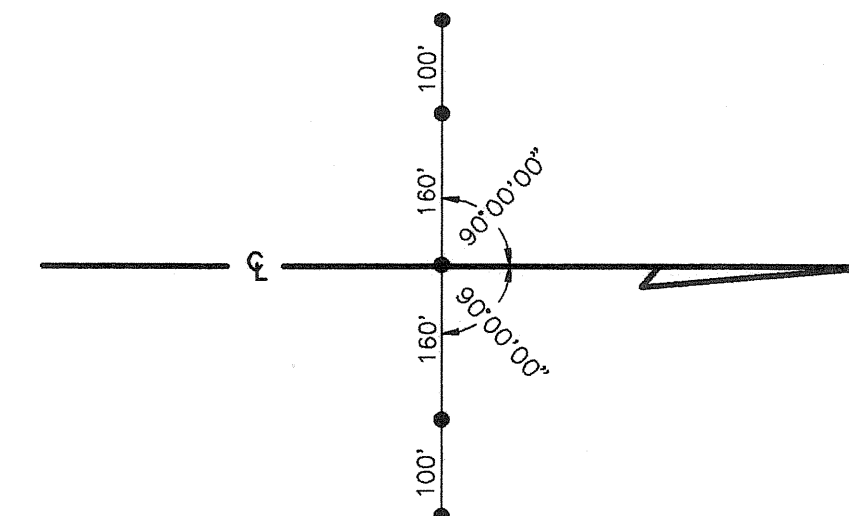

P.O.T.
STA. 260+00

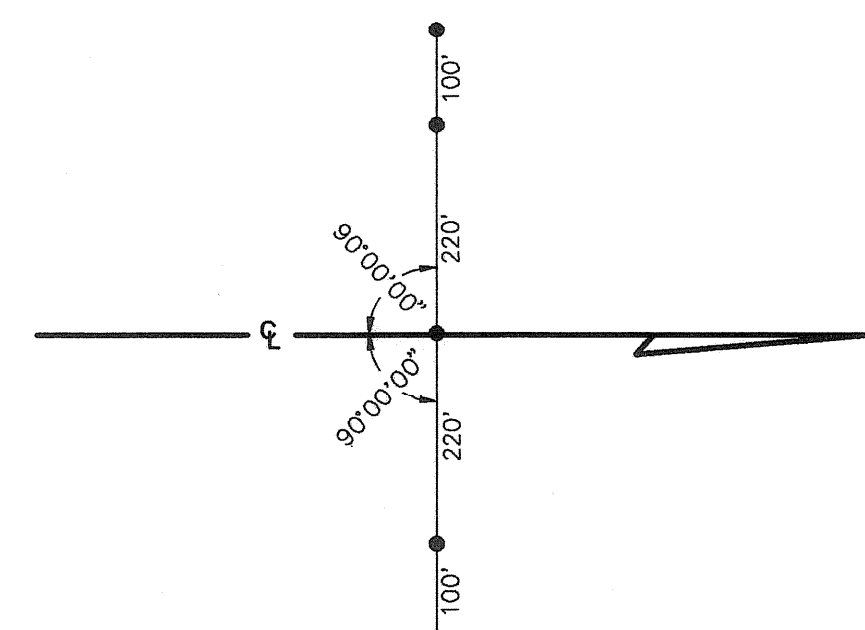

P.O.T.
STA. 270+00

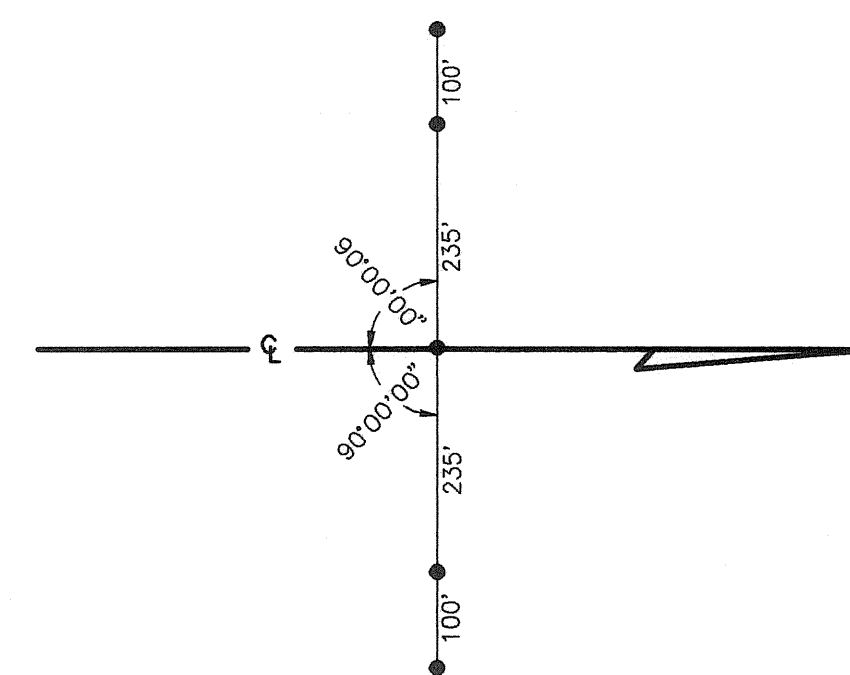

END R/W PROJECT
STA. 272+00

ALL IRONS SET W/CAPS
MARKED LS 2247

SCALE: 1"=200'

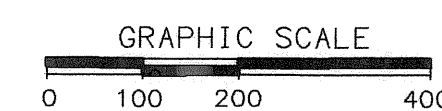

TOWNSHIP 25 SOUTH - RANGE 27 EAST

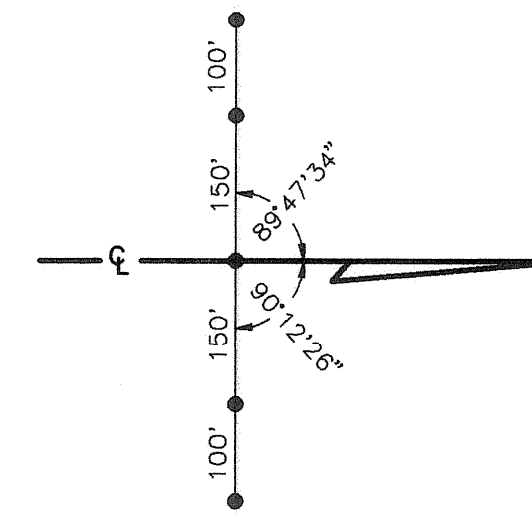

BEGIN R/W PROJECT
STA. 500+00

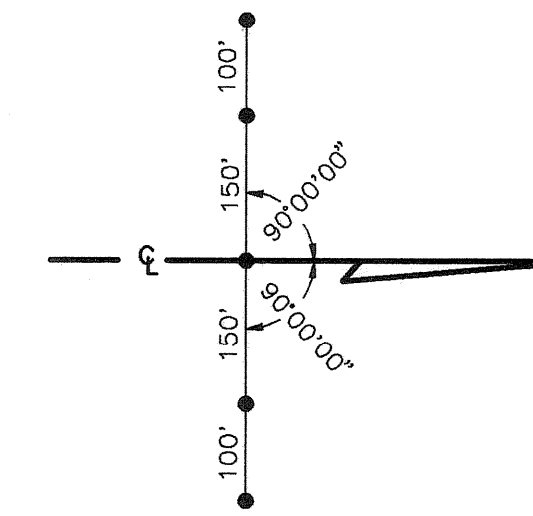

P.O.T.
STA. 510+00

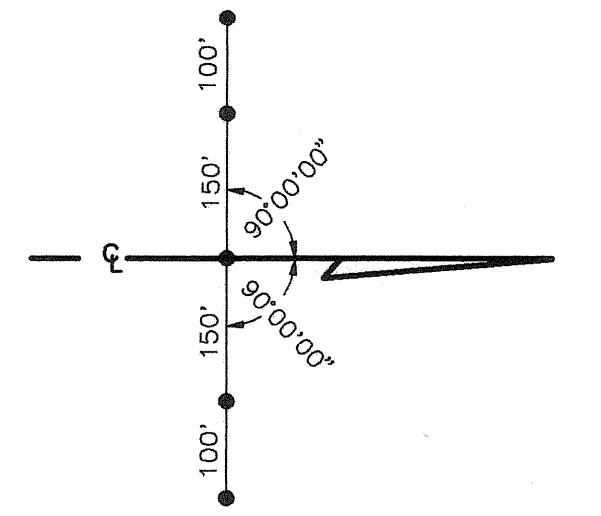

P.O.T.
STA. 520+00

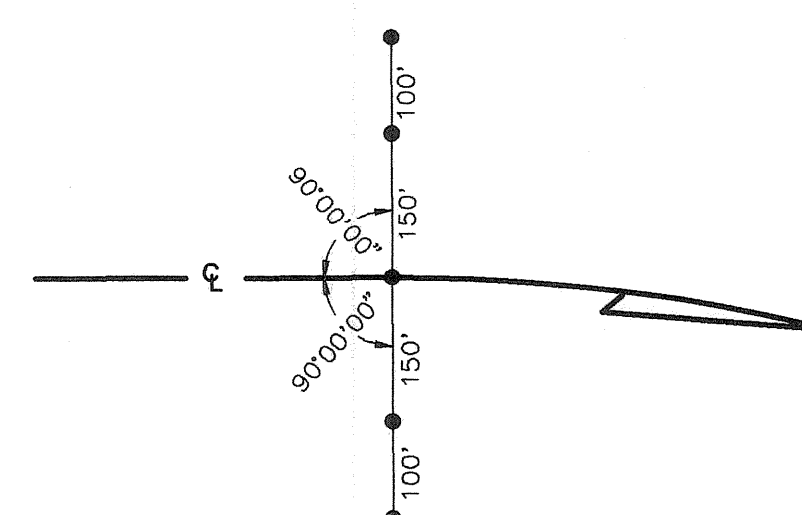

P.C.
STA. 526+84.00

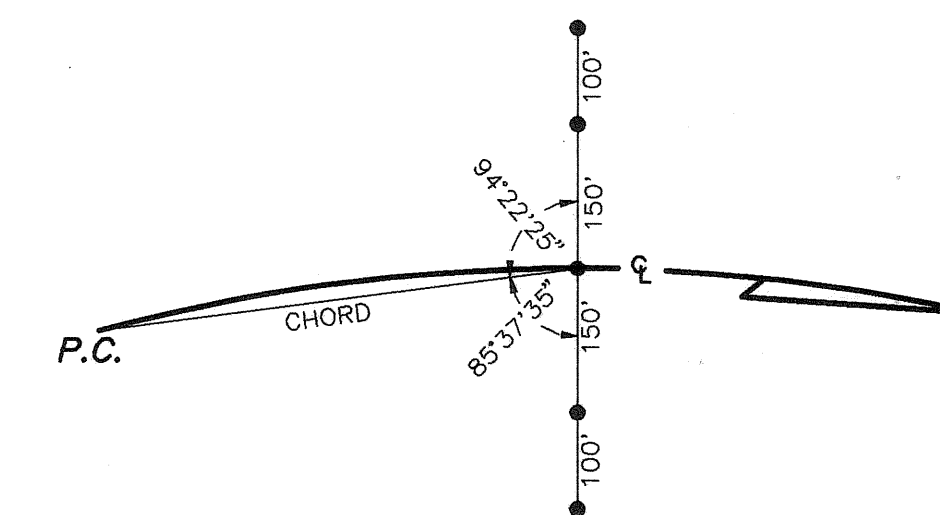

P.O.C.
STA. 530+00

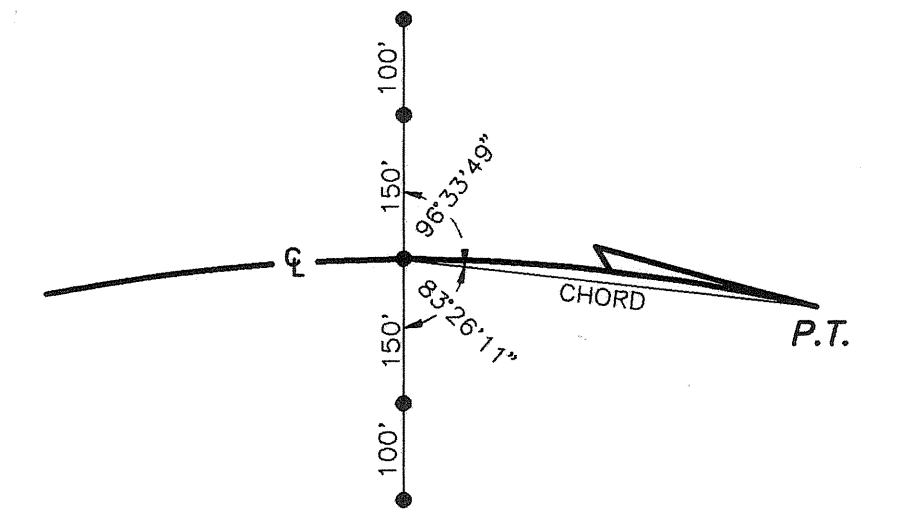

P.O.C.
STA. 540+00

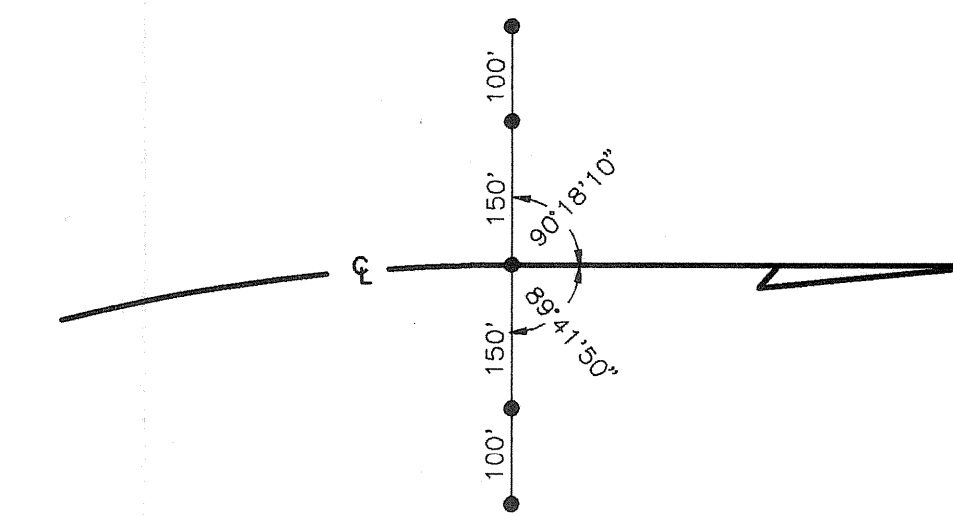

P.T.
STA. 544+37.57

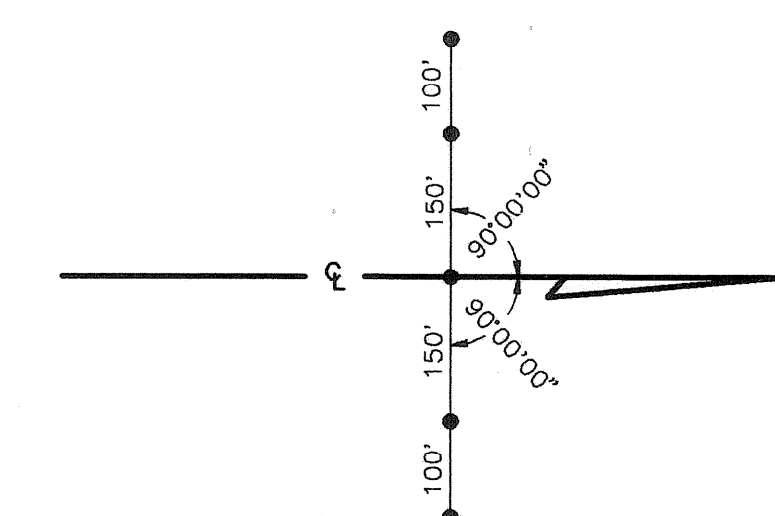

P.O.T.
STA. 550+00

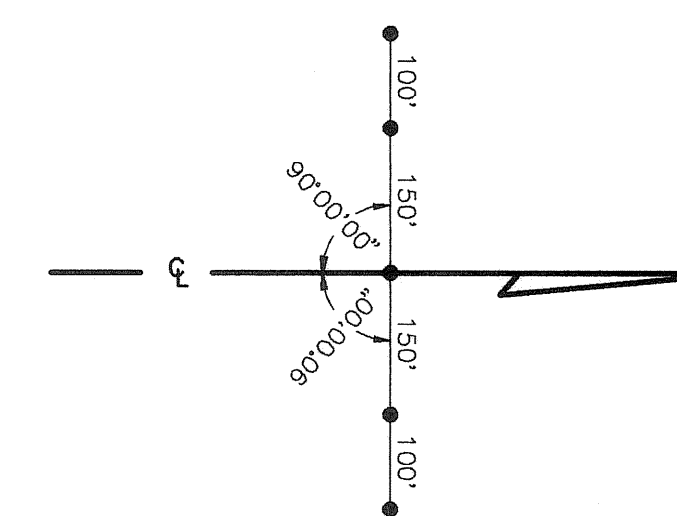

P.O.T.
STA. 551+45.03

CONTROL POINT
REFERENCES

SEE SHEET 1 FOR GENERAL NOTES & LEGEND

FLORIDA DEPARTMENT OF TRANSPORTATION
RIGHT OF WAY MAPPING

RIGHT OF WAY MAP

STATE ROAD NO. S.R. 400 (I-4) OSCEOLA COUNTY

BY	DATE	APPROVED BY	DATE
PRELIMINARY	M. RUSSELL	MAR. 1993	
FINAL	W. BYRD	AUG. 1995	
CHECKED	J. PETERSEN	AUG. 1995	

MAPS PREPARED BY
SOUTHEASTERN SURVEYING & MAPPING CORP.

FIELD BOOK NO'S
N/A

W.P.I. NO. 5147334 SCALE 1"=200'

REV. SHEET NO. R. McCRAY 4-25-00

REVISION BY DATE SECTION 92130-2426 SHEET 7 OF 8

S.R. 400 (I-4) / WORLD DRIVE INTERCHANGE